

B R O T E C

# TURBOFIL 3

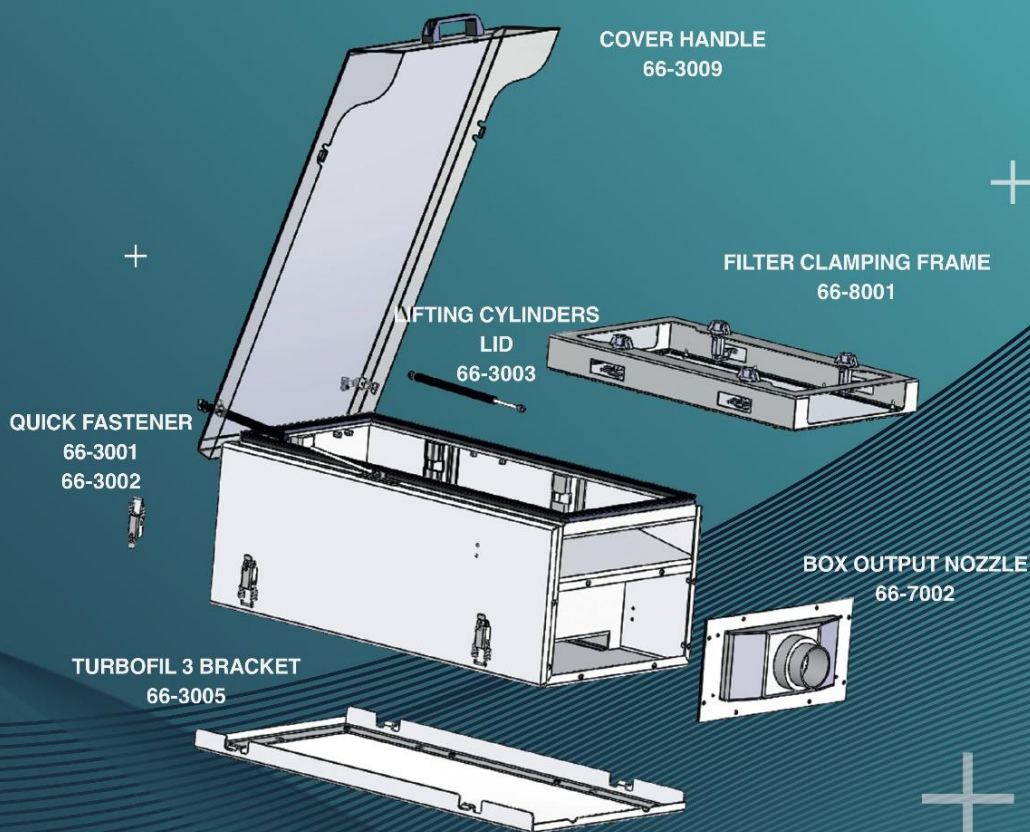

# TECHNICAL CHARACTERISTICS



<b>Housing :</b>	Stainless steel . 304
<b>Supply voltage :</b>	24Vdc (12Vdc possible)
<b>Start current :</b>	10A
<b>Operating current :</b>	6A
<b>Average air flow :</b>	80m <sup>3</sup> /h
<b>Outlet diameter :</b>	80mm/100mm
<b>Air flow control :</b>	Blower speed, regulated by the pressure instruction in the cabin.
<b>Sound level :</b>	< 70Db
<b>Weight (empty) :</b>	35kg

## C O N T A C T



271 Rue du champ de courses,  
38 780 Pont-Évêque



[www.brotec-france.fr](http://www.brotec-france.fr)



+33(0)4 74 20 58 57



[info@brotec-france.fr](mailto:info@brotec-france.fr)